

FOR REFERENCE ONLY

A NX304AB1B

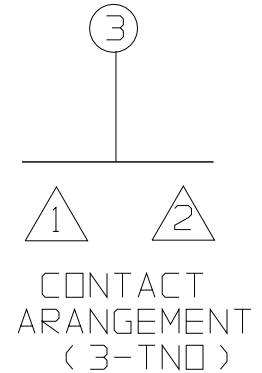
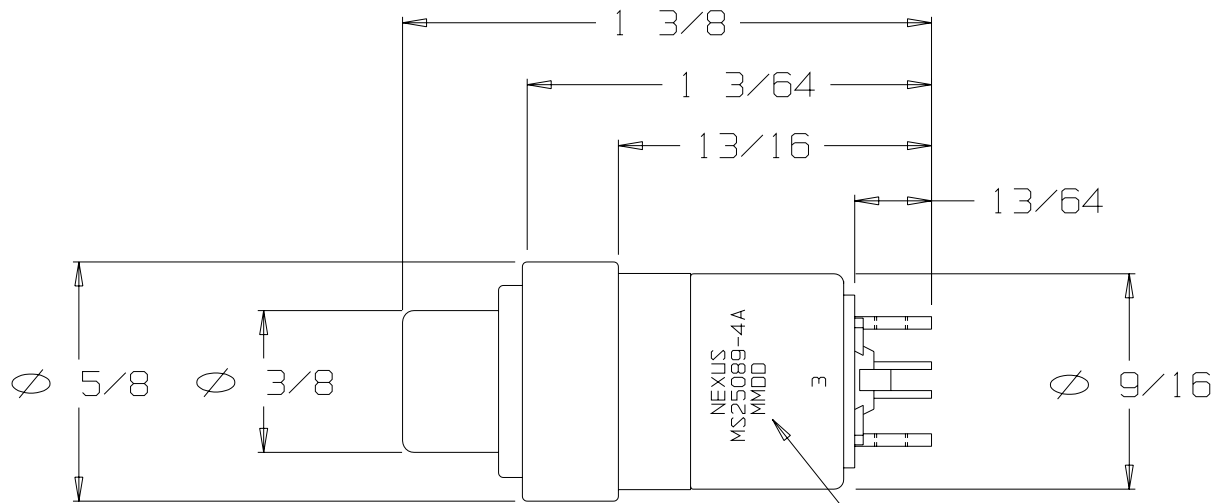

"MMDD" IS THE DATE CODE

DUSTPROOF "SERIES 300" MOMENTARY SWITCH
 CONTACTS 3-TNO - THREE TERMINAL NORMALLY OPEN
 ADAPTER TYPE "A", COLOR BLACK
 BUTTON #1, COLOR BLACK

THIS DOCUMENT CONTAINS PROPRIETARY INFORMATION OF NEXUS, INCORPORATED AND SUCH INFORMATION MAY NOT BE DISCLOSED TO OTHERS FOR ANY PURPOSE OR USED FOR ANY PURPOSE WITHOUT THE WRITTEN CONSENT OF NEXUS.

DWN. BY	EWT	DATE	3/1/06	MATERIAL	N/A	
CHECKED BY		DATE		FINISH	N/A	
APPR. BY		DATE		WEIGHT	SCALE	2:1
UNLESS OTHERWISE SPECIFIED DIMENSIONS ARE IN INCHES TOLERANCES ON .XX .XXX ANGLES _____ ±.003 ±.5°				TITLE		NEXUS STAMFORD, CONN
				SWITCH MOMENTARY		
LET.	REVISION	CN #	DATE	CHK.	DO NOT SCALE DWG.	SHEET 1 OF 1
A	INITIAL RELEASE		3/1/06	EWT	SIZE	DWG. NO.
					A	NX304AB1B