

A NX305AB1B

FOR REFERENCE ONLY

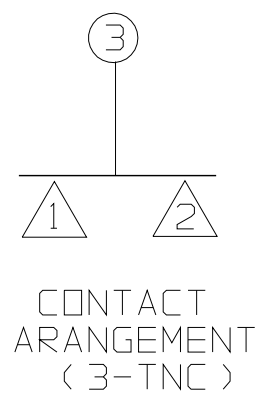
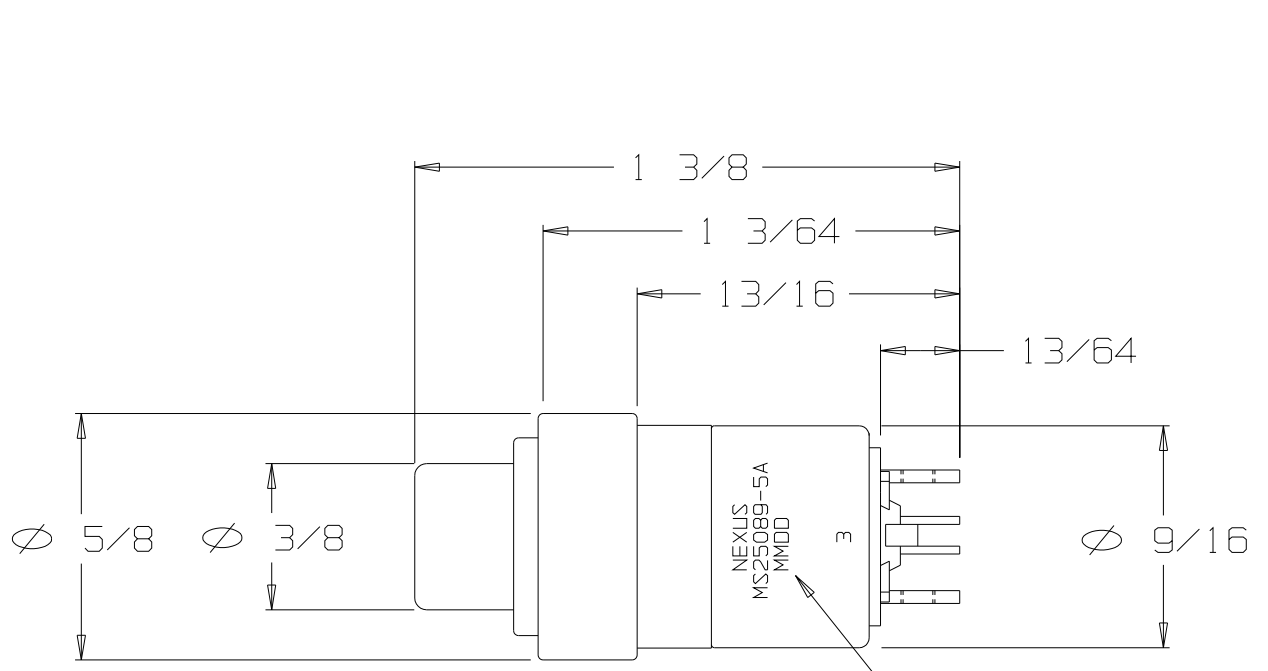

"MMDD" IS THE DATE CODE

DUSTPROOF "SERIES 300" MOMENTARY SWITCH
 CONTACTS 3-TNC - THREE TERMINAL NORMALLY CLOSED
 ADAPTER TYPE "A", COLOR BLACK
 BUTTON #1, COLOR BLACK

THIS DOCUMENT CONTAINS PROPRIETARY INFORMATION OF NEXUS, INCORPORATED AND SUCH INFORMATION MAY NOT BE DISCLOSED TO OTHERS FOR ANY PURPOSE OR USED FOR ANY PURPOSE WITHOUT THE WRITTEN CONSENT OF NEXUS.

DWN. BY		HR		DATE		7/15/13		MATERIAL		N/A	
CHECKED BY				DATE				FINISH		N/A	
APPR. BY				DATE				WEIGHT		SCALE 2:1	
UNLESS OTHERWISE SPECIFIED DIMENSIONS ARE IN INCHES TOLERANCES ON		.XX		.XXX		ANGLES		TITLE SWITCH MOMENTARY			
		±.003		±.003		±.5°					
DO NOT SCALE DWG.		SHEET 1 OF 1		SIZE A		NEXUS STAMFORD, CONN DWG. NO. NX305AB1B					
LET.		REVISION									

A	INITIAL RELEASE		7/15/13	HR
LET.	REVISION	CN #	DATE	CHK.